



DCS-F5604EM

4MP FIXED DOME NETWORK CAMERA

KEY FEATURES

OPTICS

- Day/Night Functionality
- Smart IR, up to 30 m (98 ft) IR Distance
- 3D DNR (Digital Noise Reduction)

COMPRESSION

- Ultra 265,H.265,H.264,MJPEG
- ROI (Region of Interest)

NETWORK

- ONVIF Conformance

STRUCTURE

- Wide Temperature Range: -30°C to 60°C (-22°F to 140°F)
- Wide Voltage Range of ±25%
- IP67
- 3-Axis

DIMENSIONS

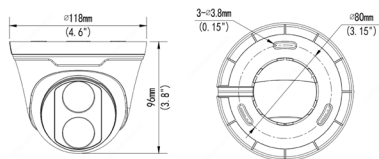

Camera					
Sensor	1/3", 4.0 megapixel, progressive scan, CMOS				
Lens	2.8mm@F2.0				
DORI Distance	Lens	Detect(m)	Observe(m)	Recognize(m)	Identify(m)
	2.8mm	42	16.8	8.4	4.2
	4.0mm	60	24	12	6
Angle of View(H)	104.4°				
Angle of View (V)	54.4°				
Angle of View (O)	135.7°				
Shutter	Auto/Manual, 1~1/100000 s				
Adjustment Angle	Pan: 0°~360°		Tilt: 0°~90°	Rotate: 0°~360°	
Min. Illumination	Colour: 0.03 Lux (2.0, AGC ON) 0 Lux with IR				
IR Range	Up to 30m (98 ft) IR range				
Day/Night	IR-cut filter with auto switch (ICR)				
S/N	>52dB				
WDR	DWDR				
Noise Reduction	2D/3D				
Video					
Video Compression	Ultra 265,H.265,H.264,MJPEG				
Frame Rate	Main Stream:4MP (2592*1520): Max. 20 fps; Sub Stream:720P (1280*720): Max. 30 fps; Third Stream:D1 (720*576): Max. 30 fps				
HLC	Supported				
BLC	Supported				
OSD	Up to 4 OSDs				
Privacy Mask	Up to 8 areas				
ROI	Up to 2 areas				
Motion Detection	Up to 4 areas				
Network					
Protocols	IPv4,IGMP,ICMP,ARP,TCP,UDP,DHCP, RTP,RTSP,RTCP,DNS,DDNS,NTP,FTP,UPnP,HTTP,HTTPS,SMTP, SSL				
Compatible Integration	ONVIF(Profile S,Profile T),API				
Interface					
Network	10/100M Base-TX Ethernet				
General					
Power	12 V DC±25%, PoE (IEEE802.3 af) Power Consumption: Max 4W				
Dimensions (Ø x H)	Ø118x 96 mm (Ø4.6" x 3.8")				
Weight	0.35kg (0.77lb)				
Working Environment	-30°C ~ +60°C (-22°F ~ 140°F), Humidity :10%~90% RH (non-condensing)				
Ingress Protection	IP67				